

Multi-lamp, solid state light engine, recessed linear wall grazer with flangless housing, nominal 2" (51mm) wide aperture and regressed acrylic lens. May be used as a wall grazer (U3) or a general down light (U4). Used in low ceiling heights to highlight the texture in surfaces such as stucco or brick, illuminate flat surfaces such as venetian plaster, fabric or wood, or specular surfaces such as polished stone or stainless steel.

**JOB:** \_\_\_\_\_  
**SPECIFIER:** \_\_\_\_\_  
**TYPE:** \_\_\_\_\_  
**QUANTITY:** \_\_\_\_\_  
**SIGNATURE:** \_\_\_\_\_

**SPECIFICATIONS**

**HOUSING**

- Extruded aluminum housing with utrim plaster frame

**MOUNTING**

- Recessed in sheetrock ceiling

**ELECTRICAL**

- Integral dimmable electronic driver with internal short circuit protection

**LAMP**

- 2 watt LED supplied with fixture

**SOCKET**

- Circuit board mounted to extruded aluminum heatsink
- Inline connectors allow removal and replacement

**LENS**

- Acrylic diffusing lens. Others available consult factory

**TRIM**

- Lens frame integral to housing
- ST is flanged trim fully sealed and gasketed. Aperture lens required

**FINISH**

- Powder paint on all surfaces in black and white as standard
- Additional colors and RAL palette available
- Custom finishes available

**LABELS**

-  , US tested to UL standards 1598, Damp location, Wet with ST trim

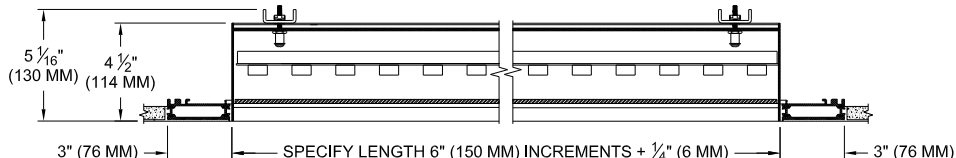
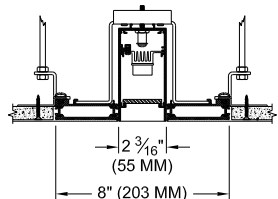
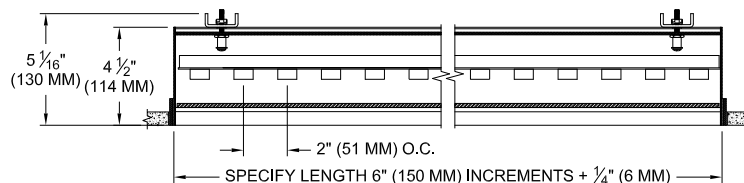
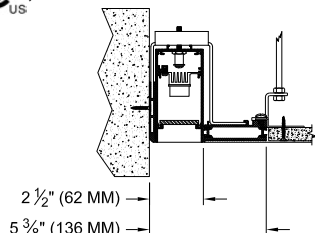
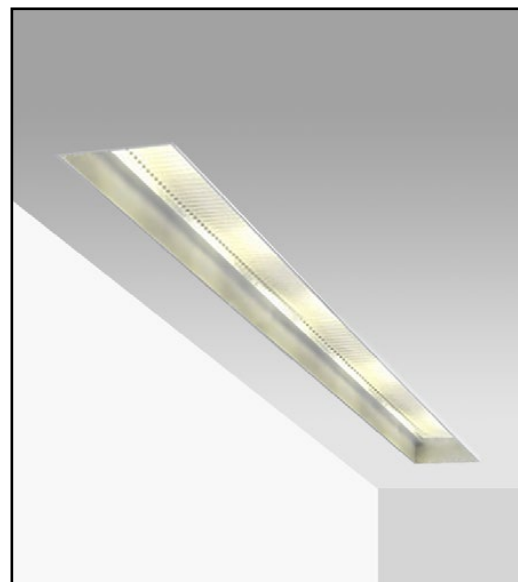

4U - FOUR SIDED ULTRIM FRAME

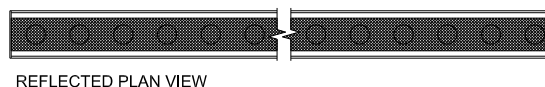

**ORDERING INFORMATION**

805-LED-PH	LENGTH	SOURCE / DRIVER	FINISH	APERTURE LENS	ACCESSORIES
Plaster Housing 8 = 80 CRI 27 = 2700K 9 = 90+CRI 30 = 3000K 35 = 3500K	Specify exact length in increments of 12" (300 mm) Min. 2' required for integral driver	UN2** = 120v-277v, 0-10v Dim. 9W/ft 1100lm/ft (nom.) UN3 = 120v-277v, 0-10v Dim. 9W/ft 600lm/ft (nom.) UN5 = 120v-277v, 0-10v Dim. 12W/ft 700lm/ft (nom.) *Add L2, LTB for Lutron 2 wire, Lutron Fade-to-Black L2 = 120v, Lutron Hi-lume 1% 2-wr LED driver 9W/ft 1100lm/ft (nom.) LTB = 120-277v, Fade-to-Black Lutron Hi-lume 1% digital EcoSystem driver 12W/ft 700lm/ft (nom.)	WHT = White BLK = Black PXX = SLI Color XXXX = RAL # CST = Custom	79A = Veiling Acrylic 91A = Solite	ST = Shower Trim* LC = Lens Clip 3U = 3 Side Ultrim 4U = 4 Side Ultrim  *Aperture lens required

\*\*UN2 for use with 90+CRI

Patent Pending.  
 These specifications subject to change without notice.

**www.specialtylightingindustries.com**  
 1306 Doris Avenue, Ocean, NJ 07712 USA  
 800.462.7812 732.517.0800 FAX: 732.517.0971

