

TYPE: \_\_\_\_\_

JOB: \_\_\_\_\_

**SPECIFICATIONS**

**HOUSING** - Precision die-formed, heavy gauge, c.r.s. Welded end plates, no visible seam.

**ELECTRICAL** - MR-16, remote transformer required, sold separately. Maximum 60 watts per foot.

**SOCKET** - Precision die formed aluminum socket plate. G-4/G-6 with 250°C 600v Teflon coated lead wires.

**MOUNTING** - Recessed, for installation in millwork ceiling.

**LABELS** - UL, C-UL -Dry Location.

**LAMP** - MR-16, 12w, 20w (narrow spot recommended) - by others.

**LENS** - Supertex borosilicate glass.

**HOUSING FINISH** - Black powder paint on all recessed surfaces.

**BAFFLE FINISH** - RAL colors standard, consult factory for custom finishes.

**APPLICATIONS**

Large profile, recessed, designed to graze down walls and other flat surfaces by positioning the trim of the fixture housing near the surface to be illuminated.

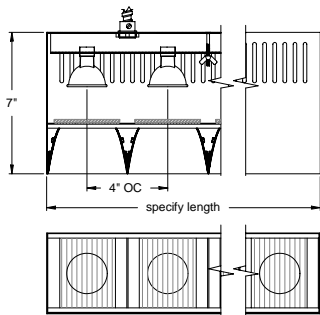
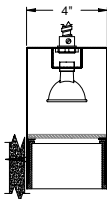

**ORDERING INFORMATION**

FIXTURE	LENGTH	BAFFLE FINISH
#811MR16 WD		
Recessed linear wall grazing system	specify exact length	<b>WHT</b> = White <b>BLK</b> = Black <b>XXXX</b> = RAL # <b>CST</b> = Custom (must supply chip)



**SPECIALTY LIGHTING**  
INDUSTRIES, INC.

www.specialtylightingindustries.com

1306 DORIS AVENUE, OCEAN, NJ 07712 USA

800.462.7812 732.517.0800 FAX 732.517.0971