

TYPE: _____

JOB: _____

SPECIFICATIONS

HOUSING - Precision die-formed heavy gauge CRS. Aluminum flange.

ELECTRICAL - ALR, remote transformer required, sold separately.

SOCKET - Precision die formed aluminum socket plate. Nickel plated steel, single contact, bayonet base with stainless steel spring for optimum contact, 250°C 125v 500w Teflon coated lead wires.

MOUNTING - Recessed, with flange.

LABELS - UL, C-UL, Dry Location.

LAMP - ALR-12, 12v, 20w (narrow spot recommended) - by others.

LENS - Solite glass. Others available, consult factory.

HOUSING FINISH - Black powder paint on all interior surfaces.

TRIM FINISH - RAL colors standard, consult factory for custom finishes.

APPLICATIONS

Small aperture, recessed downlight. Perfect for small niches, general downlighting, and cabinet lighting.

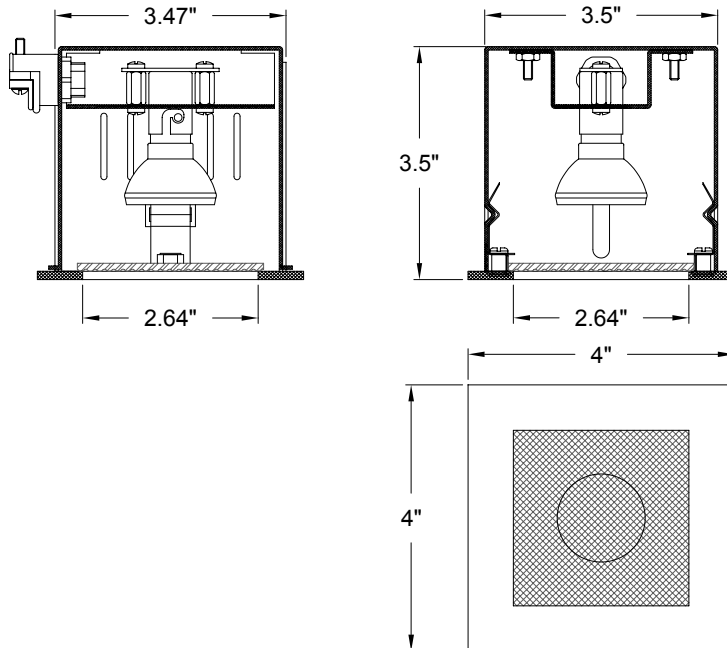

ORDERING INFORMATION

FIXTURE	TRIM FINISH
#1700	
Recessed downlight	WHT = White BLK = Black XXXX = RAL # CST = Custom (must supply chip)



SPECIALTY LIGHTING INDUSTRIES, INC. © 2004

1306 DORIS AVENUE, OCEAN, NJ 07712 USA

800.462.7812

www.specialtylightingindustries.com

732.517.0800 FAX 732.517.0971

These specifications subject to change without notice.

#1700 INSTALLATION

1. Connect power supply to fixture housing.
2. Slip fixture through opening in ceiling and pass brackets through slots in fixture.
3. Using #8-32 pan head screw, secure ceiling between fixture flange and bracket.
4. Install lamps, test with power, install trim with lens.

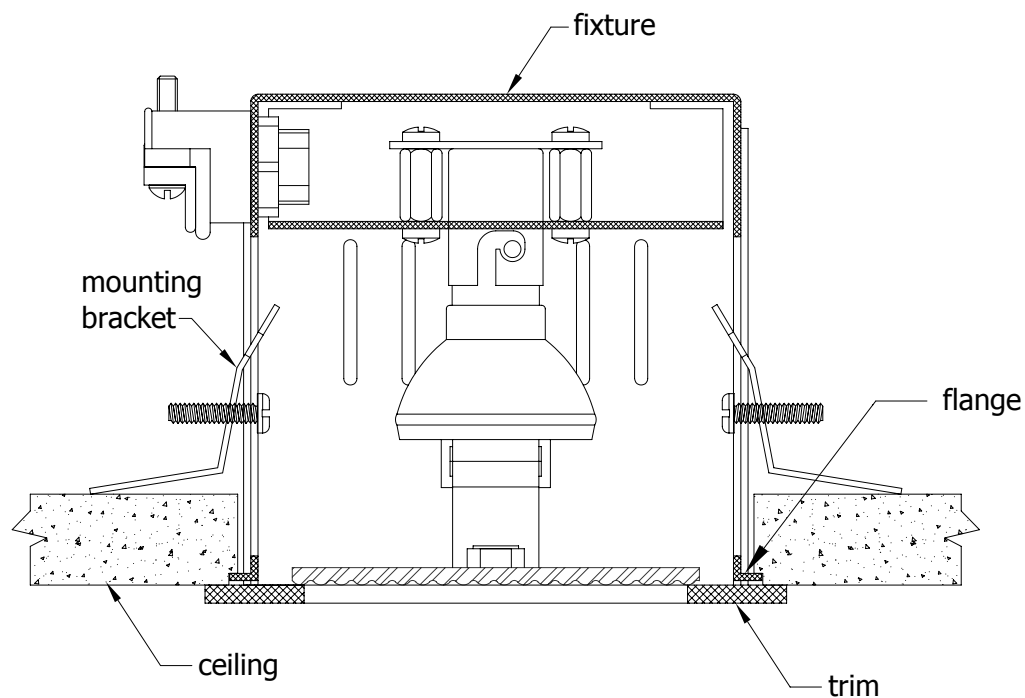

SPECIALTY LIGHTING

INDUSTRIES, INC. © 2004

1306 DORIS AVENUE, OCEAN, NJ 07712 USA

800.462.7812

www.specialtylightingindustries.com

732.517.0800 FAX 732.517.0971

These specifications subject to change without notice.