

TYPE: \_\_\_\_\_

JOB: \_\_\_\_\_

**SPECIFICATIONS**

**HOUSING** - Precision die-formed heavy gauge c.r.s. with louvered vents to prevent light leaks.

**ELECTRICAL** - Integral toroidal transformer, compact high efficiency design. Thermal protector, standard. Primary lead 120v (available: 277v, 220v, 240v.) Secondary max load 11.75v, dimmable.

**MOUNTING** - Recessed, millwork ceiling.

**LABELS** - ETL/UL - Damp Location.

**LAMP ASSEMBLY** - Precision CNC machined aluminum lamp assembly and black anodized snoot. Holds up to 2 accessories, sold separately. Ceramic socket (250°C 600v Teflon coated lead wires.)

**LAMP** - MR-16, 50w - by others.

**TRIM** - Precision CNC machined aluminum, removable for relamping.

**FINISH** - Black powder paint on all interior surfaces. Powder paint finish on trim. RAL colors standard, consult factory for custom finishes.

**APPLICATIONS**

Multiple square aperture, recessed accent light with flangeless beveled trim. Perfect for retail, residential, or commercial applications.

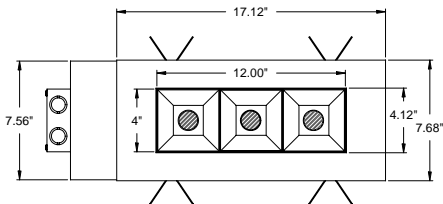
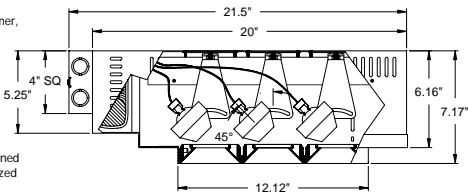

**ORDERING INFORMATION**

FIXTURE	TRIM FINISH
<b>#1050SN-3 WD</b>	
Multiple square aperture recessed adjustable accent light	<b>WHT</b> = White <b>BLK</b> = Black <b>XXXX</b> = RAL # <b>CST</b> = Custom (must supply chip)



**SPECIALTY LIGHTING  
INDUSTRIES, INC.**

www.specialtylightingindustries.com

1306 DORIS AVENUE, OCEAN, NJ 07712 USA

800.462.7812

732.517.0800

FAX 732.517.0971